

Corner in  
18" Hemlock

6.5'  
S 25° 15' W I.P.

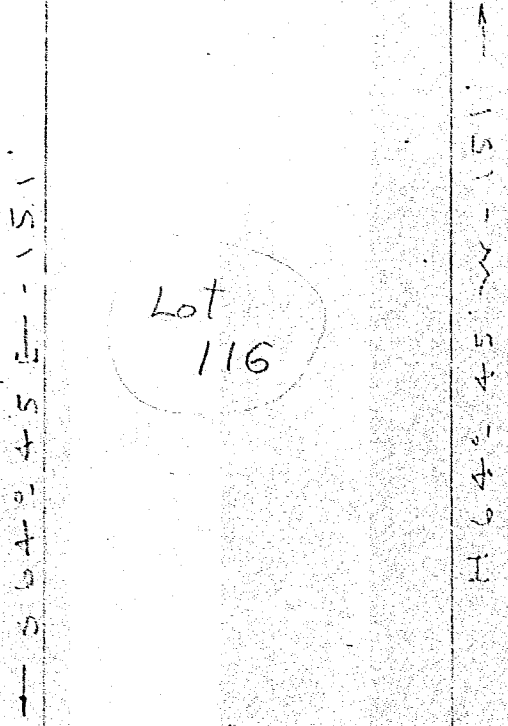

Lot  
116

17894  
AUG 12 1953

Lot 115

Lot 117

S.P. 6.5' I.P. 260' to  
S 25° 15' E → Rodney Ave.  
RUTLEDGE AVE.

PROPERTY OF  
B. H. TRAMMELL  
Part Lot 116 - Sans Souci Devel. Co.  
Near Greenville - S.C.  
Scale 1" = 30' - June - 12 - 53

185-186

B. H. Trammell - L.S. 805

#17894 Filed This 12 day of Aug. 1953  
and Recorded in Vol. DD Page 183 at

Edna H. Hainsworth